

ResMed

Fitting Guide for AirFit™ P10



- Hold the pillows at your nose ensuring that the pillow size indicator is on the bottom and you can see the left (L) and right (R) orientation indicators.



- Stretch the lower strap around the back of your head.
- The top strap should sit comfortably on top of your head.



- Pull the headgear over your head by holding the lower strap.

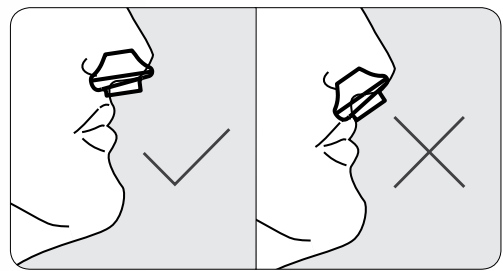

- Move the mask away from your face then place it back again.
- Ensure the nasal pillows fit securely into your nostrils with both pillows positioned upright.



- Finally, connect the end of the mask's tube into your device's air tubing and then turn on your device.
- Your mask is now ready to use.



- To achieve a comfortable fit, simply adjust the upper and lower straps by spreading them apart to loosen, or drawing them closer together to tighten.

Note: For complete user instructions, refer to the AirFit P10 User Guide.

Rx Only



ResMed Ltd
1 Elizabeth Macarthur Drive,
Bella Vista, NSW 2153 Australia

DISTRIBUTED BY
ResMed Corp
9001 Spectrum Center Boulevard, San Diego, CA 92123 USA

AirFit is a trademark of ResMed Ltd. Specifications may change without notice.
© 2013 ResMed Ltd. 1016808/1 2013-10

www.resmed.com

AirFit™ P10
Nasal Pillows System